

Sounds:
Variations on a 'Still' Point
 Conceived by Elizabeth Atkinson
 Text by Samuel Beckett

Sound Designer:
 Elizabeth Atkinson

Groundplan
 & Section

Date: 4/27/12

Scale: 1/4"=1'0"

Plate:
1
 of 2

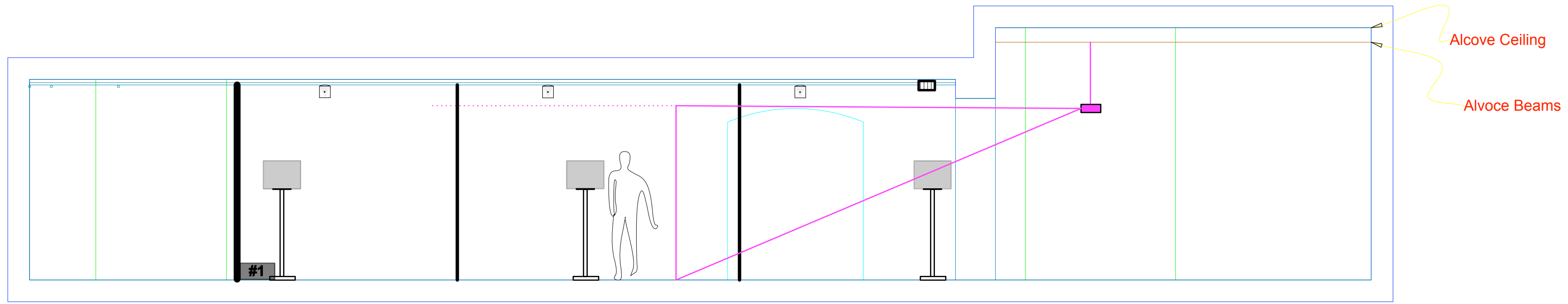

SR

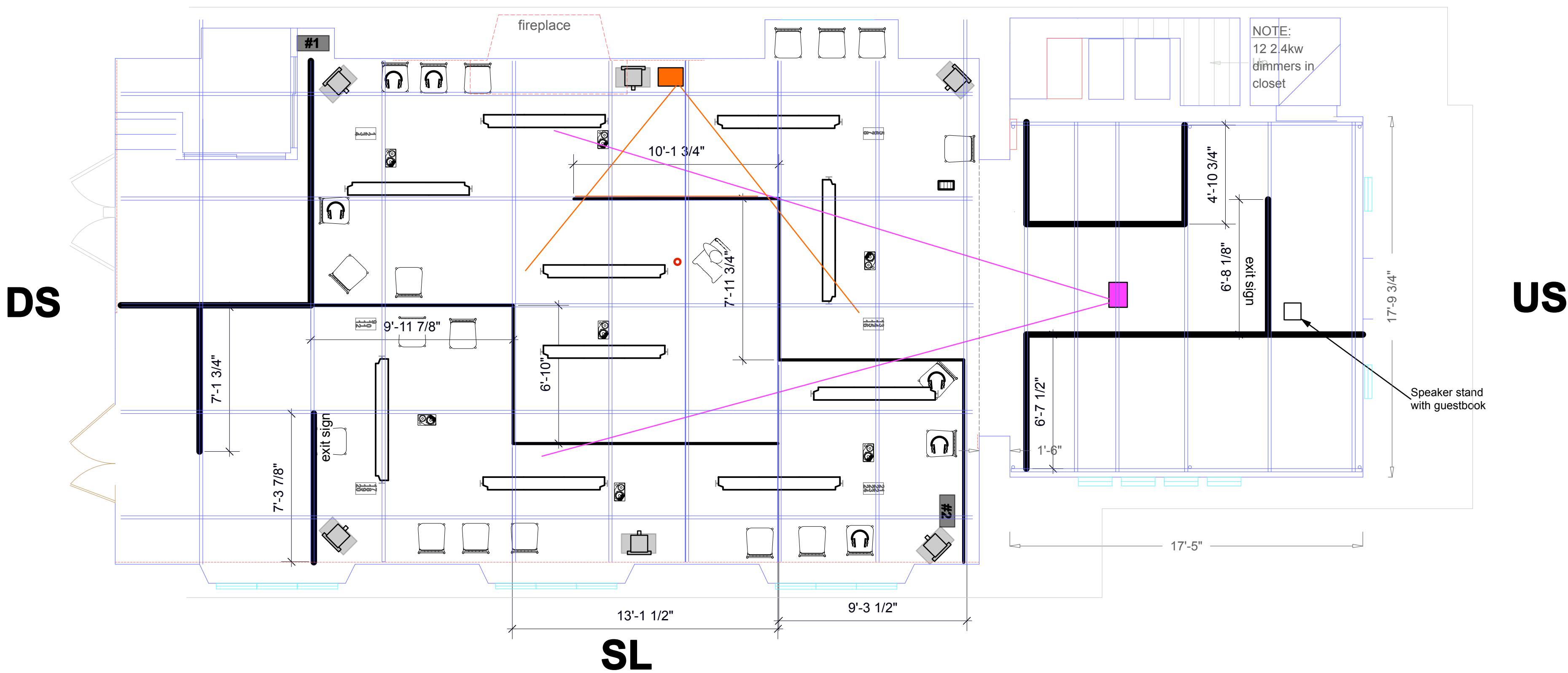

SL

Key:

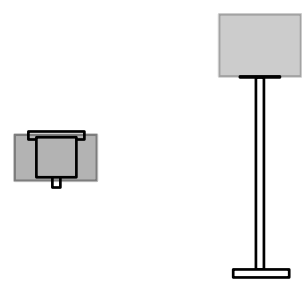

JBL LSR12P
 on speaker stand



EAW UB12se
 focused at ceiling



#1 BGW Systems
 Model 100 amplifier



#2 QSC Series
 Three Amplifier



Headphones



Snake Head



Velours



Scrim

Notes:

- Chair placement is a little TBD till we get in the space
- All soft goods should be hung at least 1'0" below pipe grid
- On the JBL LSR12P's, dip switched 1-5 should be up.
- Mackie's from Blue Room need to move to Studio A to replace JBL LSR12P's main L and R